

Rhode Island Airport Corporation
 NORTH CENTRAL STATE AIRPORT
 SMITHFIELD - LINCOLN, RHODE ISLAND
ULTIMATE
 AIRPORT LAYOUT PLAN

DESIGNED BY: THE Louis Berger Group, Inc.
 AVIATION SERVICES
 20 Corporate Woods Blvd, Albany, NY 12211

SCALE: 1" = 300'
 DRAWING NO. 3
 SHEET NO. 3 OF 6

DATE: 03/20/10
 NS: DATE: 03/20/10
 MC: DATE: 03/20/10
 CHECKED: DATE: 03/20/10

REVISIONS

Rev.	DATE	DATE
Rev.	DATE	DATE
Rev.	DATE	DATE

GRAPHIC SCALE
 1 inch = 300 ft.
 (IN FEET)
 0 150 300 450 600

RHODE ISLAND AIRPORT CORPORATION

MANAGER OF ENGINEERING
 ORIGINAL SIGNED BY: _____
 DATE: _____

EXECUTIVE VICE PRESIDENT
 DATE: _____

PRESIDENT AND CEO
 DATE: 9/1/10

U.S. DEPARTMENT OF TRANSPORTATION
 NEW ENGLAND REGION
 APPROVED: _____
 AIRPORTS DIVISION
 DATE: C-22-10

AIRPORT DATA

EXISTING	440.5' (MSL)
AIRPORT ELEVATION	LAT 41° - 55' - 14.75"
AIRPORT REF. POINT (ARP)	LONG 71° - 29' - 28.97"
MEAN DAILY MAX. TEMP.	81°
AIRPORT AREA (ACRES)	475
AIRPORT NAVAIDS	UNCOM (122.7)
AIRPORT COMMUNICATIONS (CTAF)	AWOS-3 (120.025)
AIRPORT WEATHER REPORTING	TAXIWAY WIDTH (MIN / MAX) 40' / 50'
TAXIWAY LIGHTING	MITS
OPERATIONAL ROLE	GENERAL UTILITY
FAA ROLE	DASSAULT FALCON 50

VFR WIND COVERAGE

COMBINED	99.58
15 - 33	96.75
5 - 23	96.50
RUNWAY % COVERAGE	98.87

IFR WIND COVERAGE

COMBINED	99.89
15 - 33	90.75
5 - 23	98.87

PERIOD: JAN 1998 - DEC 2008
 SOURCE: NATIONAL WEATHER RECORDS CENTER
 LOCATION: PAVEMENT, 18

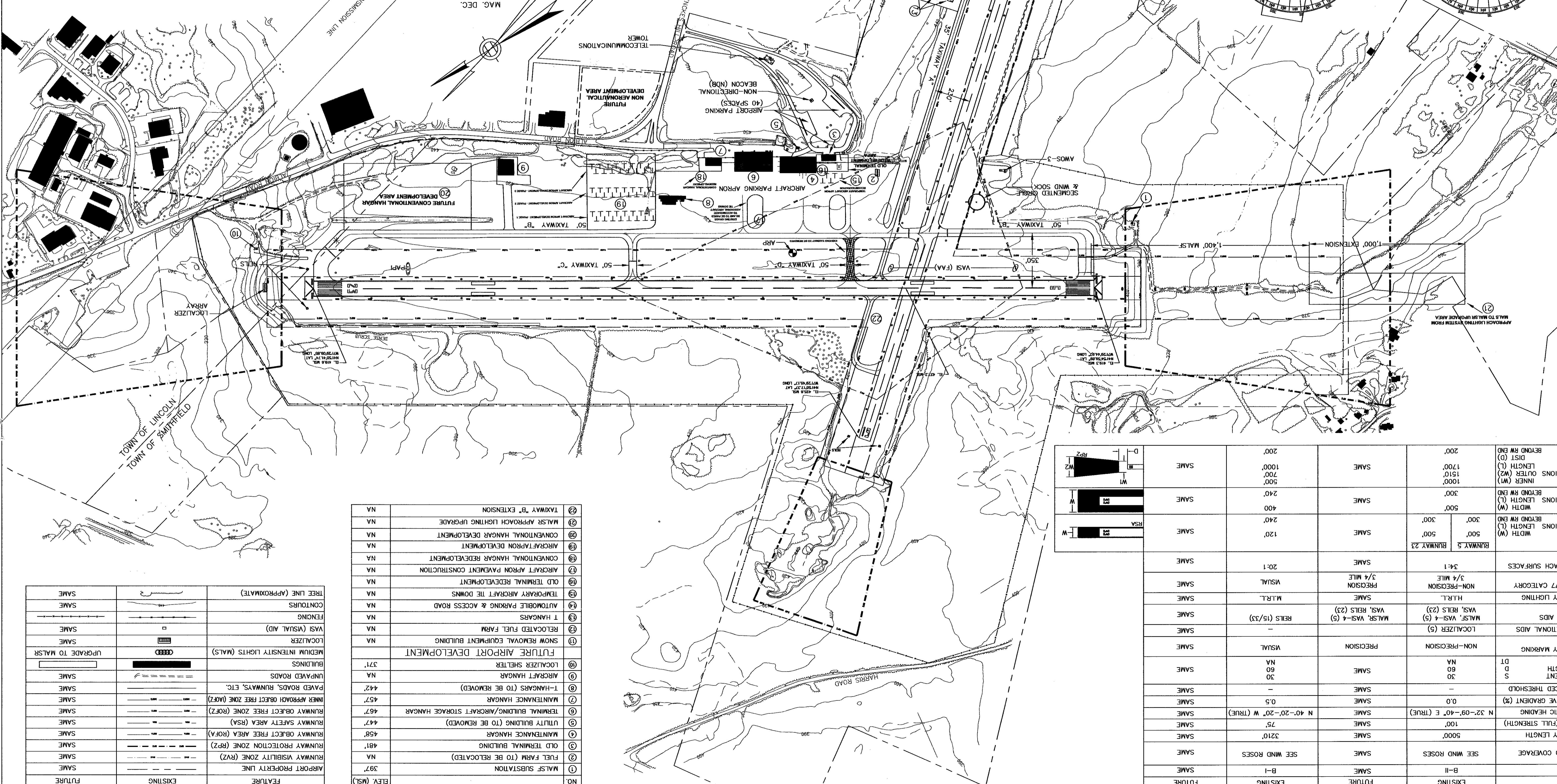
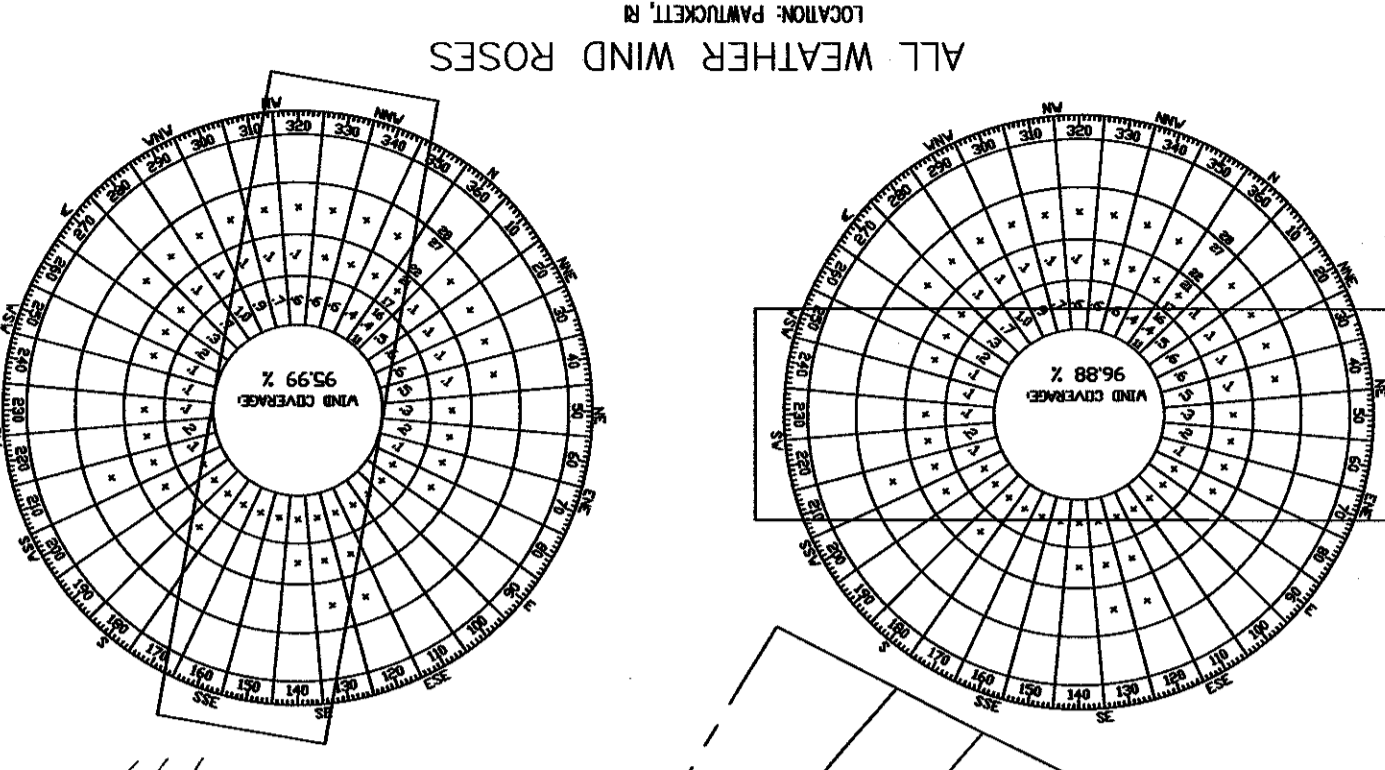

EXISTING AIRPORT FACILITIES

NO.	ELEV. (MSL)	DESCRIPTION
1	39.7'	MALSF SUBSTATION
2	NA	FUEL FARM (TO BE RELOCATED)
3	481'	OLD TERMINAL BUILDING
4	458'	MAINTENANCE HANGAR
5	447'	UTILITY BUILDING (TO BE REMOVED)
6	467'	TERMINAL BUILDING/AIRCRAFT STORAGE HANGAR
7	457'	MAINTENANCE HANGAR
8	457'	RELOCATED FUEL FARM
9	NA	T HANGARS
10	NA	TEMPORARY AIRCRAFT THE DOMS
11	NA	OLD TERMINAL REDEVELOPMENT
12	NA	AIRCRAFT APRON PAVEMENT CONSTRUCTION
13	NA	CONVENTIONAL HANGAR REDEVELOPMENT
14	NA	AIRCRAFT APRON DEVELOPMENT
15	NA	CONVENTIONAL HANGAR DEVELOPMENT
16	NA	MALSF APPROACH LIGHTING UPGRADE
17	NA	TAXIWAY 'B' EXTENSION

LEGEND

FEATURE	EXISTING	FUTURE
AIRPORT PROPERTY LINE	---	---
RUNWAY VISIBILITY ZONE (RVZ)	---	---
RUNWAY PROTECTION ZONE (RPZ)	---	---
RUNWAY OBJECT FREE AREA (ROFA)	---	---
RUNWAY SAFETY AREA (RSA)	---	---
RUNWAY OBJECT FREE ZONE (ROFZ)	---	---
INNER APPROACH OBJECT FREE ZONE (IAOFZ)	---	---
PAVED ROADS, RUNWAYS, ETC.	---	---
UNPAVED ROADS	---	---
BUILDINGS	---	---
MEDIUM INTENSITY LIGHTS (MALIS)	---	---
UPGRADE TO MALSF LOCALIZER	---	---
VASI (VISUAL AID)	---	---
FENCING	---	---
CONTOURS	---	---
TREE LINE (APPROXIMATE)	---	---

RUNWAY DATA

ARC	EXISTING	FUTURE	SEE WIND ROSES	SEE WIND ROSES
EXISTING	B-II	B-I		
FUTURE				
% WIND COVERAGE				
RUNWAY LENGTH	5000'	3210'		
WIDTH (FULL STRENGTH)	100'	75'		
MAGNETIC HEADING	N 32°-09'-40" E (TRUE)	N 40°-20'-20" W (TRUE)		
EFFECTIVE GRADIENT (%)	0.0	0.5		
DISPLACED THRESHOLD				
PAVEMENT STRENGTH	30	60		
DT	NA	NA		
RUNWAY MARKING	NON-PRECISION	PRECISION		
NAVIGATIONAL AIDS	LOCALIZER (5)			
VISUAL AIDS	MALSF, VASI-4 (5) VASI, RELS (23)	MALSF, VASI-4 (5) RELS (15/33)		
RUNWAY LIGHTING	NON-PRECISION	PRECISION		
PART 77 CATEGORY	3/4 MILE	3/4 MILE		
APPROACH SURFACES	34:1	20:1		
RSA DIMENSIONS	500' (W) 500' (L)	500' (W) 120' (L)		
ROFA DIMENSIONS	500' (W) 300' (L)	400' (W) 240' (L)		
RPZ DIMENSIONS	1000' (W) 1700' (L)	500' (W) 1000' (L)		
RUNWAY 5	200'	200'		
RUNWAY 23	300'	300'		
RUNWAY 15-33	200'	200'		